

Level 9

FINANCIAL LAYOUT

17,470 SQ FT | 1,623 SQ M

Total Workstations	200
Area per person	8 sq m
2 person quiet rooms	4
4 person meeting rooms	4
8 person meeting room	1
18 person meeting room	1
Collaboration zones	8
Breakout areas	2

- Office
- Lifts
- WCs
- Core
- Circulation

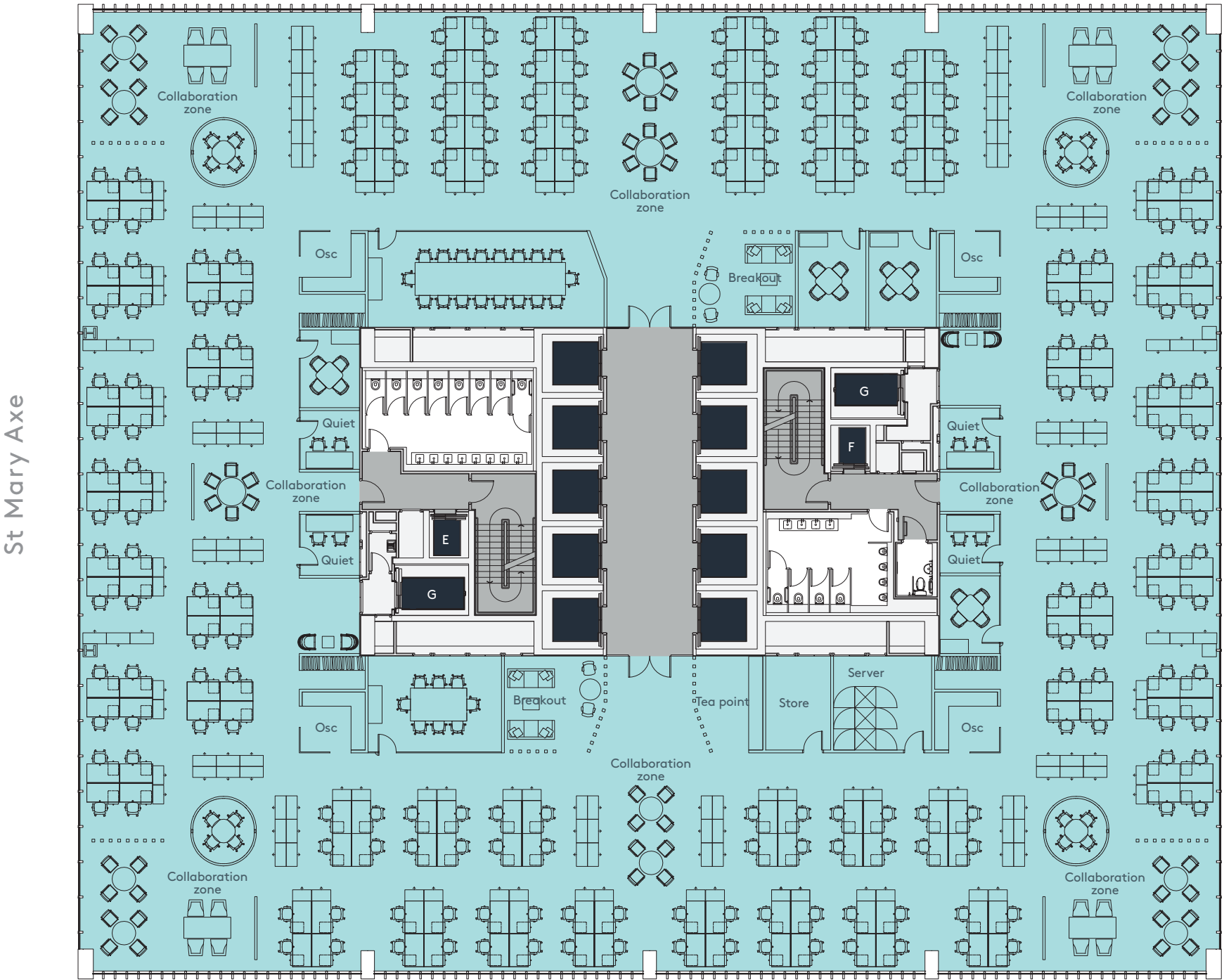

Bevis Marks

Level 9

CORPORATE LAYOUT

17,470 SQ FT | 1,623 SQ M

Total Workstations	176
Area per person	9 sq m
Single person offices	16
2 person quiet rooms	4
4 person meeting rooms	3
6 person meeting room	2
10 person meeting room	1
Collaboration zones	4
Breakout areas	2

- Office
- Lifts
- WCs
- Core
- Circulation

St Mary Axe

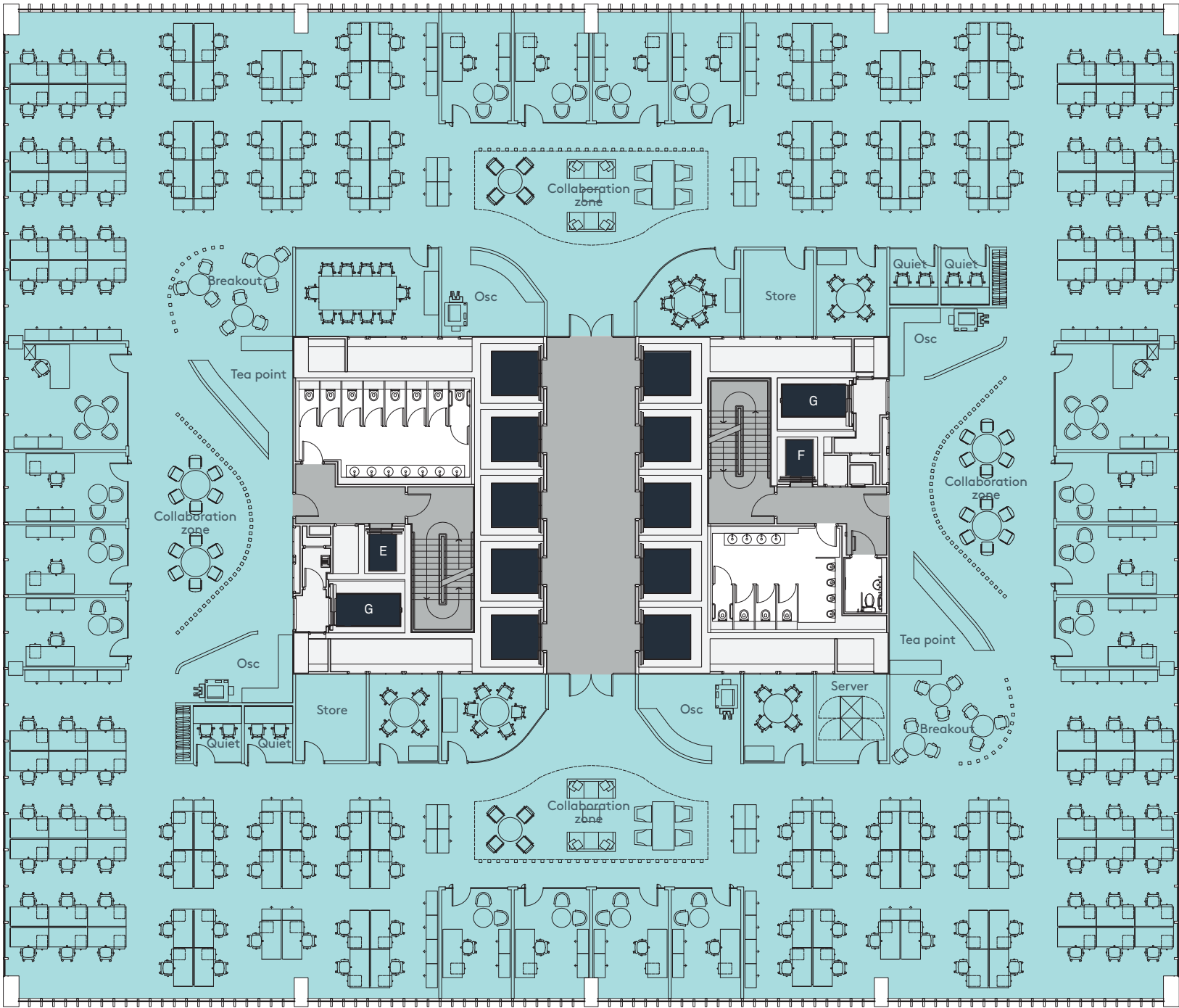

Bevis Marks



Level 9

LEGAL LAYOUT

17,470 SQ FT | 1,623 SQ M

Total Workstations	98
Area per person	16.6 sq m
Single partner offices	10
2 person offices	34
Support staff workstations	20
4 person meeting rooms	4
4 person open plan meeting tables	4
12 person meeting rooms	2
Breakout areas	2

St Mary Axe

- Office
- Lifts
- WCs
- Core
- Circulation

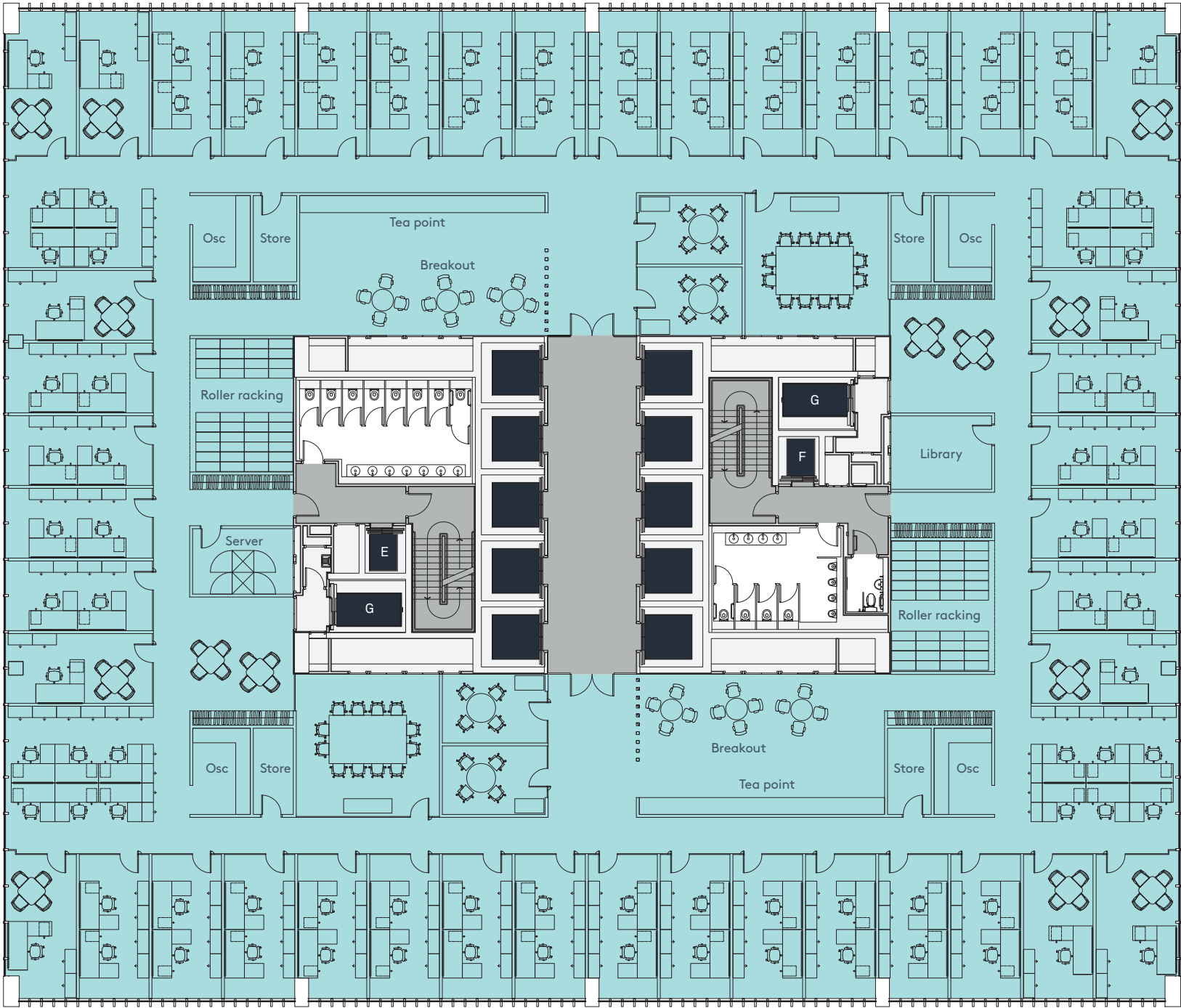

Bevis Marks



Level 20

EXECUTIVE SUITE

10,518 SQ FT | 977 SQ M

4 person meeting rooms	2
6 person meeting rooms	8
8 person meeting rooms	4
10 person meeting rooms	5
10 person meeting rooms (flexible)	3
18 person boardroom	1

St Mary Axe

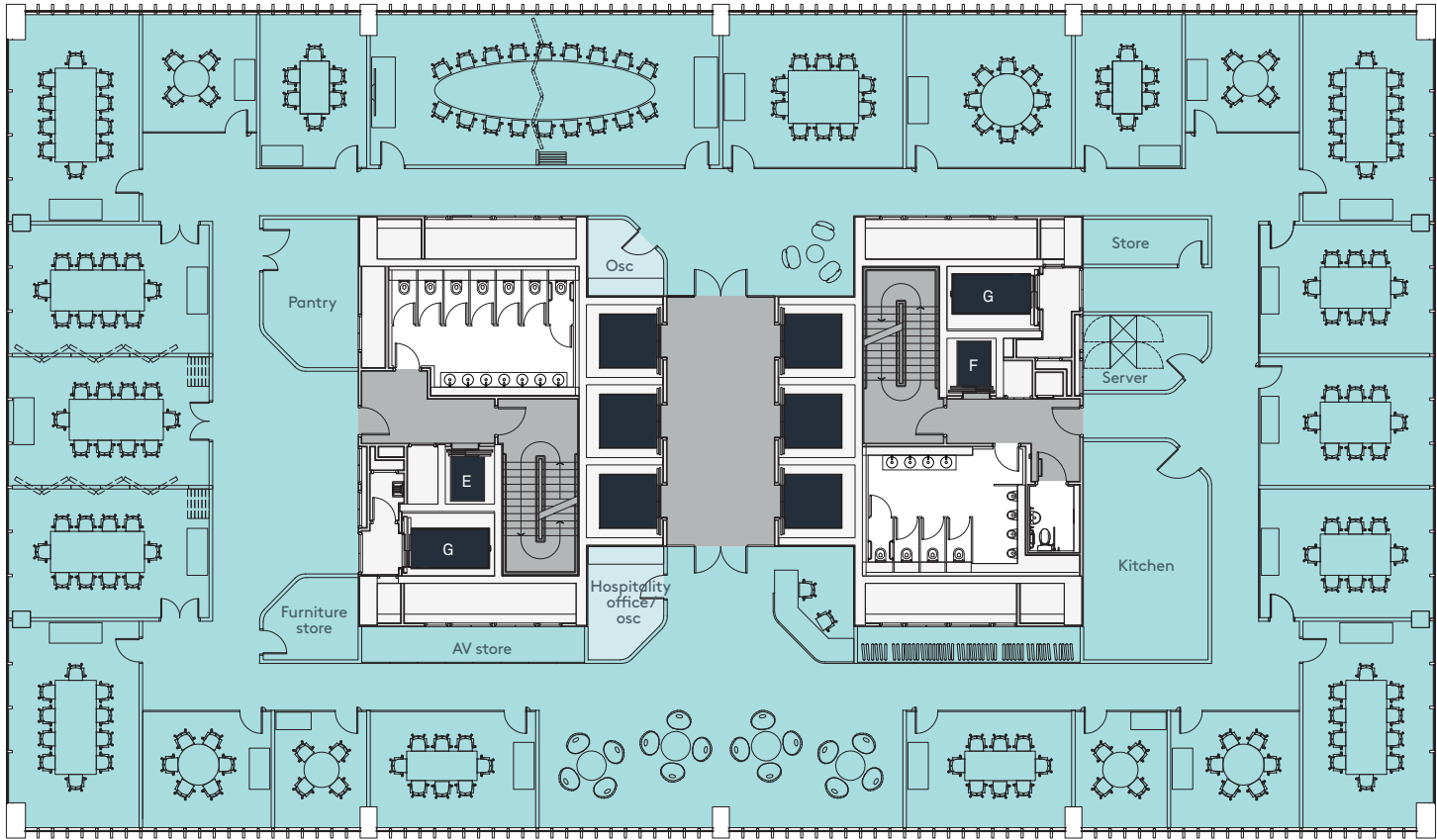

- Office
- Lifts
- WCs
- Core
- Circulation

Bevis Marks